

PIN OUT:

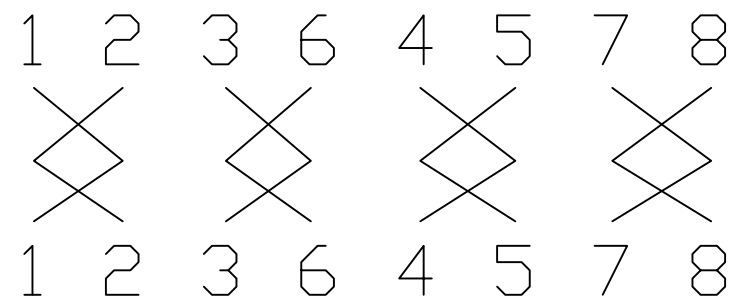

NOTES:

1. 100%OPEN&SHORT TESTING
2. VOLTAGE:300V DC
3. INSULATION RESISTANCE:20M ohm
4. CONTACT RESISTANCE:1ohm
5. Operating temperature range:0-50°C

CUSTOMER P/N	length
FE-C6270-01-BLK	1FT(305MM±30MM)
FE-C6270-02-BLK	2FT(610MM±30MM)
FE-C6270-03-BLK	3FT(915MM±30MM)
FE-C6270-05-BLK	5FT(1520MM±30MM)
FE-C6270-07-BLK	7FT(2130MM±50MM)
FE-C6270-10-BLK	10FT(3050MM±50MM)
FE-C6270-14-BLK	14FT(4270MM±80MM)
FE-C6270-20-BLK	20FT(6150MM±100MM)
FE-C6270-25-BLK	25FT(7620MM±100MM)

MY CABLE MART LLC

Title: **CAT6 ANGLED-DOWN NETWORK PATCH CORD**

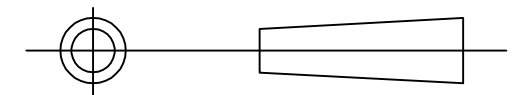

Customer: MY CABLE MART LLC

Page: 1/1

Drawn BY: **CLR**

Customer P/N:

REV: **A1**

Check BY: **DYH**

Date: 2016.08.15

Drawing NO.: FLF270

Unit: **mm**

Appd BY:

8		
7		
6		
5		
4		PE BAG+LABEL
3		PCV45Pa BLACK
2		CAT6 RJ45 MALE
1		CAT.6 UTP CABLE 24AWG(7/0.18BC)*4P OD:6.0MM BLACK
NO.	Material	Description