

REVISION RECORD			
REV.	CONTENT	MOD.	DATE
1	初版发行		

NOTES:

1. Voltage Rating: 300V, Current Rating: 15A
2. PITCH: 5.08mm
3. Insulation Withstands Voltage: AC2500V/min
4. Insulation Resistance: 5M Ω or more at DC500V
5. Using Temperature Range:-40° C - +105° C
6. Suitable Electric Wire:28-12AWG
7. Screw Torque Value: 0.5 N.m

技术要求:

1. 额定电压: 300V, 额定电流: 15A
2. 间距: 5.08mm
3. 对电压值: AC 2500V/min
4. 绝缘阻抗:5兆欧
5. 使用条件: -40° - +105°
6. 适用线规: 28-12AWG
7. 螺丝扭力:0.5 N.m

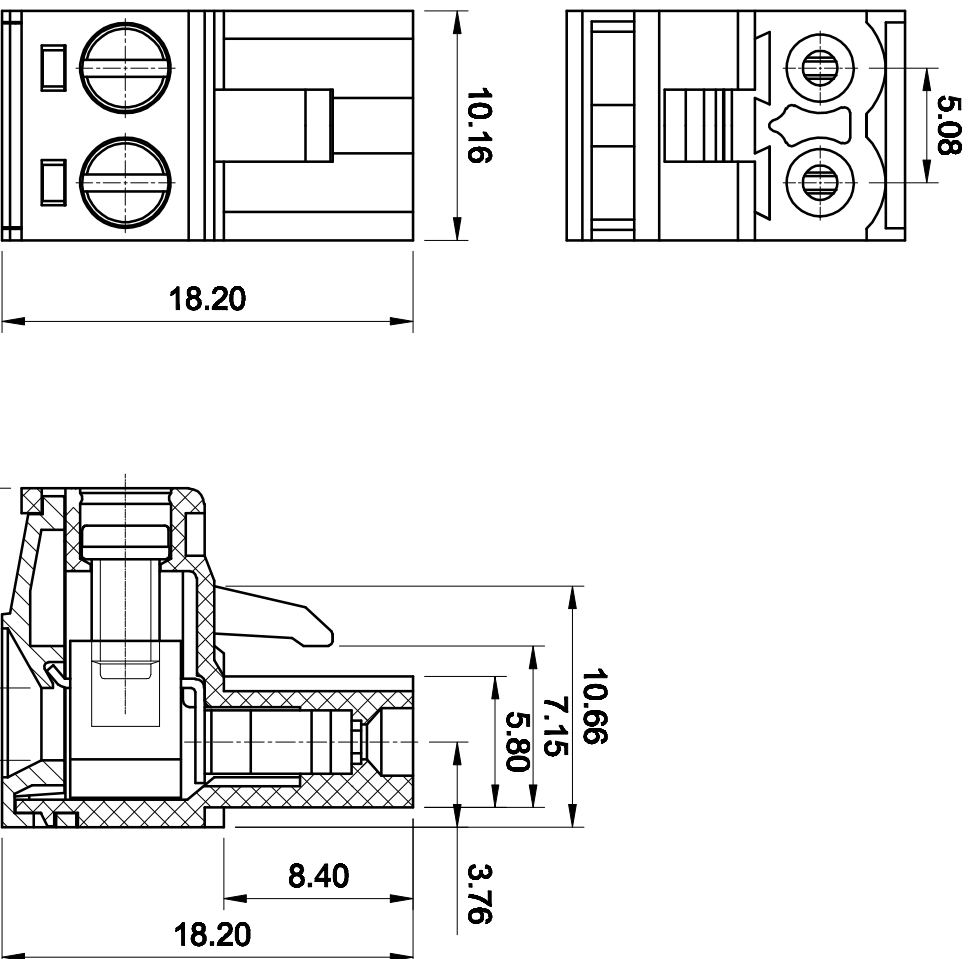

	Nominal dimension					Tolerance		
	pitch	dimension	dimension	dimension	dimension			
variable range	over 0 to 6	over 6 to 10	over 10 to 24	over 0 to 30	over 30 to 60	over 60 to 100	over 100 to 150	over 150
	±0.1	±0.15	±0.25	±0.2	±0.3	±0.5	±0.7	±1.0

NO.	NAME OF PART	NO. OF PART	Q'TY	MATERIAL	NOTES
1.	LC1-5-08-主体	1001A4002AV	1	PA66-V0	绿色
2.	LC1-5-08-盖子	1001C4002AV	1	PA66-V0	绿色
3.	LC1-5-08-螺丝	SP0VA305302Y	2	碳钢	三价铬钝化彩锌
4.	LC1-5-08-铜方块	F1A0BLC5083Y	2	黄铜	镀镍
5.	LC1-5-08-夹子	1001B0001AV	2	弹簧钢	镀镍

DES.	AKKINE	DATE	18-05-09	UNITS	MM	THIRD ANGLE PROJECTION	SHEET
CHK.		DATE		SIZE	A4		1 of 1
APP.		DATE		SCALE	1:1		REV: V0

MY CABLE MART LLC TITLE: LC1-5-08-2P-140-00A
LC1-5-08-成品